

Operation Specifications

Max Working Pressure	200 PSI [13.8 bar]
Max Temperature	250 °F [121.1 °C]
Compatible Fluids	Compatible with petroleum and alcohol fuels, petroleum and synthetic motor oils, and engine coolants (ethylene glycol)

Rebuild Kits and Torque Recommendations

Family / Size	S 	S 	L 	L 	XL 
AN Size	-6 AN & - 8 AN	-6 AN & - 8 AN	-10 AN & - 12 AN	-10 AN & - 12 AN	-16 AN & - 20 AN
Rebuild Kit	09-0900-KIT	09-0900-KIT	09-0940-KIT	09-0940-KIT	09-0980-KIT
End Cap Screw	8-32 x 1/2" Long	8-32 x 1/2" Long	10-24 x 1/2" Long	10-24 x 1/2" Long	1/4-20 x 1/2" Long
End Cap Screw Torque	14-16 in-lb	14-16 in-lb	16-18 in-lb	16-18 in-lb	20-22 in-lb
Panel Mount Thread	-	10-24	-	-	-
Max Torque, Panel Mount Screws	-	30 in-lb	-	-	-
Panel Mount Loctite	-	Loctite 222 (Purple)	-	-	-
Max Torque, Bulkhead Nut -10 AN	-	-	-	10 ft-lb	-
Max Torque, Bulkhead Nut -10 AN	-	-	-	10 ft-lb	-

TO CHANGE HANDLE ORIENTATION:

1. Turn handle 45° so that hole in handle is above the set screw.
2. Use a .050" hex key and remove set screw through the hole.
3. Determine the desired handle orientation (See p. 2). Rotate handle to desired position, then turn 45° so that the hole in the handle is above the necessary hole for the set screw.
4. Clean threads of any dirt, grease, or oil and apply Loctite 222 (purple) to 1st four set screw threads.
5. Install set screw in desired position. Install set screw deep enough that it engages the slot in the handle and allows handle to turn smoothly.

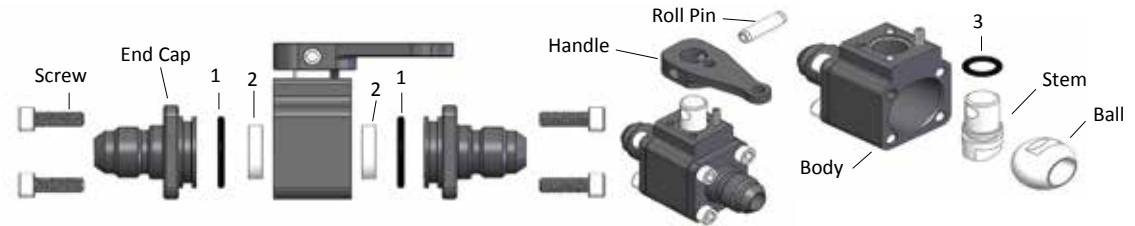
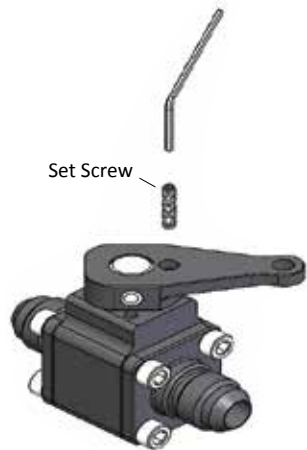

Rebuild Kits include End Cap O-Rings (Item 1), Ball Seals (Item 2), and Stem O-Ring (Item 3).

1. For best performance, lubricate O-Rings and Ball Seals (Items 1, 2, and 3) with oil prior to installation.
2. Remove Screws (Qty. 8) to separate End Caps from body.
3. To replace Stem O-Ring (Item 3 / Qty. 1), push out Roll Pin and remove Handle. Remove Ball and push Stem down and out of Body. Install new O-Ring on Stem. Reassemble Stem to its original location. Note orientation of Stem tab and Ball slot and ensure that tab is inserted in slot.
4. Reassemble Handle in desired orientation and press in Roll Pin from counterbored side of Handle.
5. Replace End Cap O-Rings (Item 1 / Qty. 2) and Ball Seals (Item 2 / Qty. 2) and reassemble End Caps to Body.
6. Install Screws and torque to value shown in table above for End Cap Screw Torque.

Dimensions

STANDARD & BULKHEAD

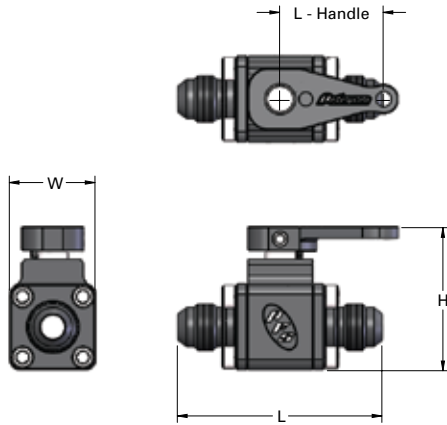

FLANGE MOUNT

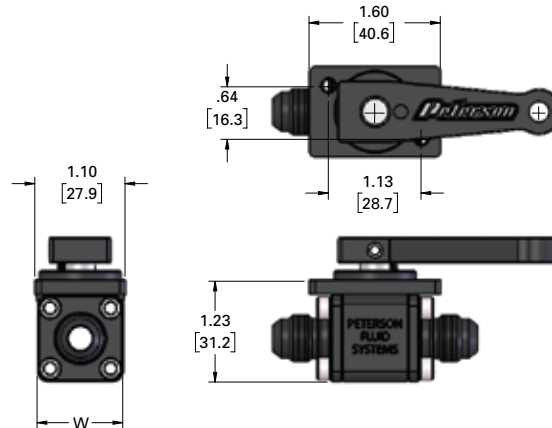

Part No.	Type	Fittings	Weight (g)	Length	Width	Height	L-Handle
09-0900	Small	-6AN	84.2	2.49 (63.3)	1.05 (26.7)	1.74 (44.2)	1.26 (32.0)
09-0903	Small	-6AN x 6AN Female	99.5	2.73 (69.3)	1.05 (26.7)	1.74 (44.2)	1.26 (32.0)
09-0910	S-Panel	-6AN	96.9	2.49 (63.3)	1.05 (26.7)	1.74 (44.2)	2.00 (50.8)
09-0920	Small	-8AN	92.6	2.70 (68.6)	1.05 (26.7)	1.74 (44.2)	1.26 (32.0)
09-0923	Small	-8AN x 8AN Female	119.7	2.94 (74.7)	1.05 (26.7)	1.74 (44.2)	1.26 (32.0)
09-0930	S-Panel	-8AN	105.3	2.70 (68.6)	1.05 (26.7)	1.74 (44.2)	2.00 (50.8)
09-0940	Large	-10AN	155.7	3.25 (82.6)	1.38 (35.0)	2.05 (52.1)	2.00 (50.8)
09-0941	Bulkhead	-10AN	183.2	4.11 (104.4)	1.38 (35.0)	2.05 (52.1)	2.00 (50.8)
09-0943	Large	-10AN x 10AN Female	166.8	3.49 (88.7)	1.38 (35.0)	2.05 (52.1)	2.00 (50.8)
09-0960	Large	-12AN	171.2	3.46 (87.9)	1.38 (35.0)	2.05 (52.1)	2.00 (50.8)
09-0961	Bulkhead	-12AN	214.1	4.39 (111.5)	1.38 (35.0)	2.05 (52.1)	2.00 (50.8)
09-0963	Large	-12AN x 12AN Female	190.0	3.62 (91.9)	1.38 (35.0)	2.05 (52.1)	2.00 (50.8)
09-0980	Ex. Large	-16AN	526.5	4.28 (108.7)	2.40 (61.0)	2.91 (73.9)	5.00 (127.0)
09-0983	Ex. Large	-16AN x 16AN Female	562.9	4.88 (123.9)	2.40 (61.0)	2.91 (73.9)	5.00 (127.0)
09-0990	Ex. Large	-20AN	563.0	4.38 (111.2)	2.40 (61.0)	2.91 (73.9)	5.00 (127.0)

Dimensions are in inches and (mm)

Handle Configurations

Handle rotates 90° and can be configured in four different orientations

Handle @45°
Set Screw Visible

Valve Open

Valve Closed

1.

Set screw at lower right



2.

Set screw at lower left

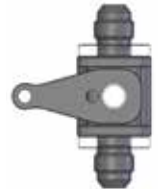

3.

Set screw at upper left



4.

Set screw at upper right

